

OPEN RANGE

2023 TRAVEL TRAILERS



38.5052° N, 122.4704° W
St. Helena, California



Experience the Open





2023 Open Range Travel Trailer 338BHS

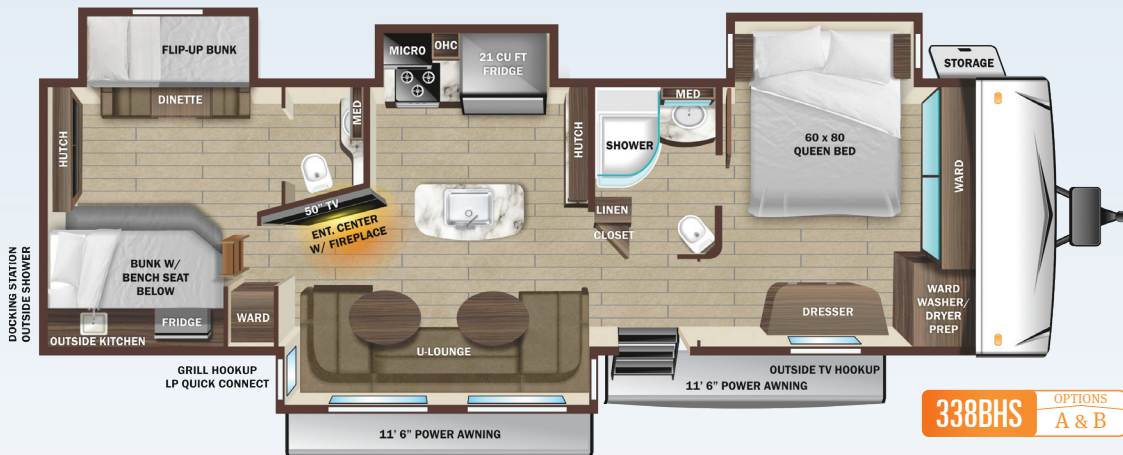

Optional 12 cu. ft. 12V refrigerator (available on all floorplans shown)

STANDARD INTERIOR EQUIPMENT

- » 21 cu. ft. residential refrigerator
- » 60" x 80" residential queen bed with storage below
- » 75 lb. ball bearing drawer guides
- » Cable and satellite prep
- » Flush floor slides with residential vinyl flooring
- » Glass shower door
- » Hardwood cabinet doors
- » Large oven and 3-burner range with flush mount glass cover
- » LED interior lighting
- » Observation camera prep
- » Residential microwave
- » Roller blackout night shades
- » USB ports in bedroom

STANDARD EXTERIOR EQUIPMENT

- » 100" wide body frame
- » 2-30 lb. LP bottles
- » 4" tube storage bumper
- » 50 amp service
- » ACCU-SLIDE™ slide system (42" deep 4-corner compression)
- » Battery disconnect switch
- » Brass hanger bushings with wet bolts
- » Equa-Flex® axle suspension
- » Exterior grill/griddle quick connect port
- » Frameless windows
- » Marine grade exterior speakers (2)
- » Norco™ 5.1 stabilizer system with BAL™ lock arms
- » PVC roofing membrane (limited lifetime warranty)
- » Rear roof access ladder

- » Self-adjusting electric brakes
- » Spare tire
- » TuffShell™ - vacuum bonded laminated construction, reinforced with heavy-duty fiberglass and welded aluminum frames

EXECUTIVE PACKAGE (MANDATORY)

- » 13,500 BTU A/C with quiet residential return air - bedroom
- » 15,000 BTU A/C with quiet residential return air - main living
- » Cutting board and sink strainer
- » Dome style digital TV antenna with Wi-Fi prep
- » Interior convenience center light
- » JBL® Aura Cube stereo with Bluetooth® and miZONE™ technology
- » JBL® Premium indoor and outdoor mutlizon speakers
- » Keyed-Alike® entry and baggage doors
- » LED HDTV
- » Painted fiberglass front cap with LED lighting
- » Power awning with LED lighting
- » Power tongue jack
- » Quick recovery gas/electric water heater
- » Quick release fresh water drain
- » Residential high-rise faucet with pull-down sprayer
- » Single basin stainless steel under-mount kitchen sink
- » Solar prep
- » Solid swing-down entry steps
- » Solid-surface kitchen countertops
- » Stainless steel appliances
- » TravelLINK® - Smart RV system that allows for Bluetooth® control of awnings, lighting, slideouts, heating, cooling and more
- » USB/12V charging port

FOUR SEASONS PACKAGE (MANDATORY)

- » Double insulated baggage doors
- » Ducted heat to underbelly with cold air return
- » Enclosed cable operated gate valves
- » Enclosed exterior docking station with black tank flush
- » Heated and enclosed underbelly
- » High performance furnace
- » R-38 reflective foil insulation in ceiling and underbelly
- » R-9 block foam insulation in sidewalls

OPTIONS

- » Xtend Solar II Package (2-200 watt solar panels with 30 amp solar controller and 1800 watt inverter)
- » 12 cu. ft. gas/electric refrigerator
- » BBQ grill
- » Dual pane windows
- » Folding dinette chairs (2)
- » Heat pump (main A/C)
- » King bed (N/A 330BHS)
- » Observation camera
- » Rear storage tray
- » Slideout awning covers
- » Theater seats and table ipo standard u-lounge sofa (330BHS, 338BHS)
- » Wall controlled power vent - bathroom
- » Wi-Fi router

SPECIFICATIONS

May Include Estimated Values

| | 322RLS | 330BHS | 338BHS |
|------------------------------------|-------------|---------|----------------|
| Unloaded Vehicle Weight (lbs.) | 9,440 | 9,920 | 10,330 |
| Dry Hitch Weight (lbs.) | 1,215 | 1,265 | 1,210 |
| Gross Vehicle Weight Rating (GVWR) | 11,500 | 11,500 | 12,000 |
| Cargo (Gross) | 2,060 | 1,580 | 1,670 |
| Exterior Length (Overall) | 37' 9" | 39' 4" | 39' 11" |
| Exterior Height | 11' 11" | 11' 11" | 11' 11" |
| Exterior Width | 8' 4" | 8' 4" | 8' 4" |
| Exterior Width (Slides Out) | 13' 11" | 13' 11" | 15' 2" |
| Interior Height (Overall) | 7' 0" | 7' 0" | 7' 0" |
| Fresh Water Capacity (Gal.)* | 56 | 49 | 49 |
| Gray Waste Water Capacity (Gal.) | 114 | 84 | 66 |
| Black Waste Water Capacity (Gal.) | 31 | 33 | 66 |
| LP Capacity (lbs.) | 60 | 60 | 60 |
| Tire Size | 16" | 16" | 16" |
| Awning Size | 11' 6", 14' | 19' | 11' 6", 11' 6" |

*Includes Water Heater

TO LEARN MORE VISIT
openrangerv.com



Highland Ridge RV – Part of the Jayco Family of Companies



LOCAL DEALER INFO



Due to continual research and advances, manufacturer reserves the right to change specifications, design, price, and equipment without notice, and assumes no responsibility for any error in the literature. Some items shown are not included as standard or optional equipment. 2032623.2023