

# RANGE LITE AIR

2023 TRAVEL TRAILERS



35.7140° N, 83.6532° W  
Wears Valley, Tennessee

*Ready for the Journey*





2023 Range Lite Air 19MBH

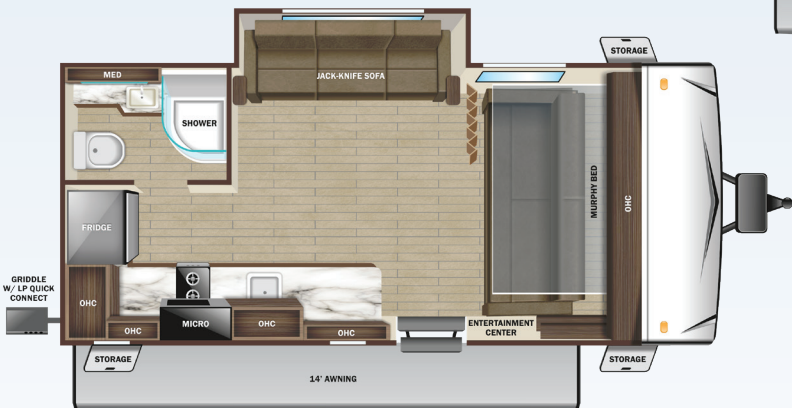
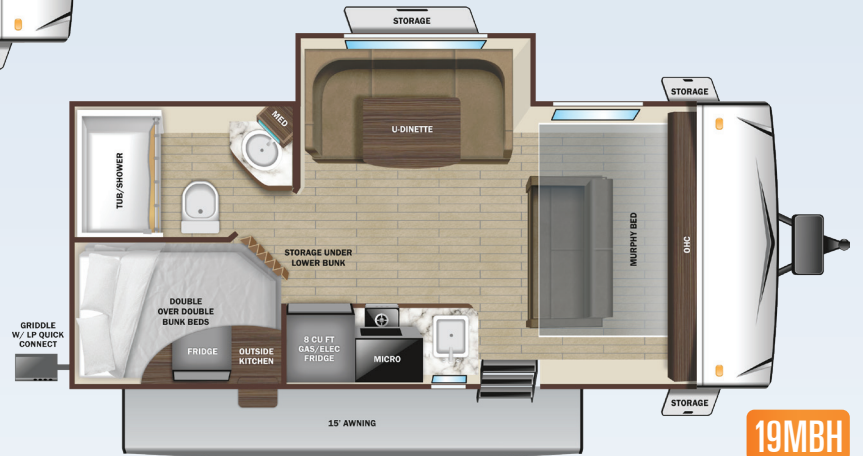
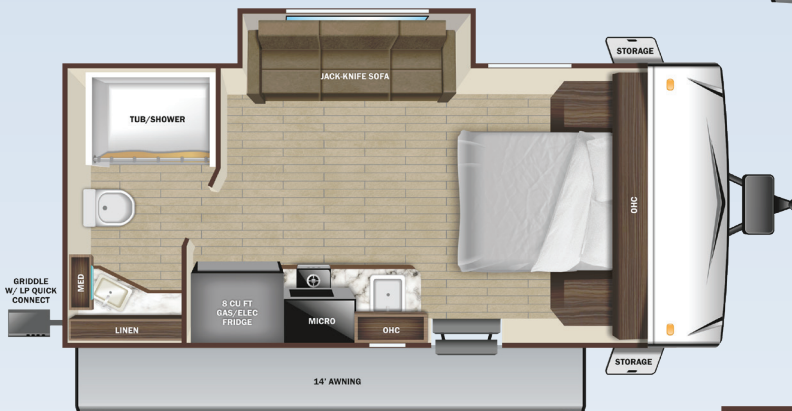

Optional 8 cu. ft. gas/electric refrigerator (available on all floorplans shown)

## STANDARD INTERIOR EQUIPMENT

- » 2-burner recessed range with flush mount glass cover
- » 75 lb. ball bearing drawer guides
- » 80" bed
- » 81" interior height
- » Bathroom skylight and roof vent
- » Cable and satellite prep
- » Convection microwave
- » Deep bowl kitchen sink
- » Electrical outlets and USB ports in master bedroom
- » LED interior lighting
- » Range hood
- » Residential high-rise faucet
- » Residential vinyl flooring
- » Roller blackout night shades
- » Seamless pressed membrane countertops
- » Soft closing foot flush toilet

## STANDARD EXTERIOR EQUIPMENT

- » 30 amp service
- » Dome style digital TV antenna with Wi-Fi prep
- » Exterior grill/griddle quick connect port
- » Flexible LP lines
- » Fully walkable roof
- » Impact resistant galvanized steel wheel wells
- » Magnum Roof™ system
- » Molded front cap with LED lighting
- » Power awning
- » PVC roofing membrane (limited lifetime warranty)
- » Rear observation camera prep
- » Rear roof access ladder

- » Roof mount accessory rack
- » Single axle design
- » Solid swing-down entry steps
- » Tinted safety-glass windows throughout
- » TuffShell™ - vacuum bonded laminated construction, reinforced with heavy-duty fiberglass and welded aluminum frames

## CUSTOMER CONVENIENCE PACKAGE (MANDATORY)

- » 15" nitrogen filled off-road radial tires with aluminum rims
- » 15,000 BTU A/C
- » 2-30 lb. LP bottles
- » 32" 12V LED TV
- » Detachable power cord
- » Enclosed, insulated underbelly and fully insulated roof
- » Gas/electric water heater
- » Inverter pre-wire
- » JBL® Aura Cube stereo with Bluetooth® and miZONE™ technology
- » Power tongue jack
- » Rubber torsion axle with increase ground clearance adjustments
- » Side camera prep marker lights
- » Spare tire
- » Stabilizer jacks

## OPTIONS

- » Xtend Solar I Package (200 watt solar panel with 30 amp controller) (mandatory)
- » 8 cu. ft. gas/electric refrigerator
- » 110V tank heat pads
- » Wi-Fi router

SPECIFICATIONS May Include Estimated Values	16FBS	17BH	18RBS**	19MBH	17MDS
	Unloaded Vehicle Weight (lbs.)	3,795	3,685	4,015	4,420
Dry Hitch Weight (lbs.)	470	450	490	670	415
Gross Vehicle Weight Rating (GVWR)	4,995	4,995	4,995	5,500	5,300
Cargo (Gross)	1,200	1,310	980	1,080	1,165
Exterior Length (Overall)	20' 0"	20' 7"	22' 7"	23' 7"	23' 0"
Exterior Height	10' 5"	10' 5"	10' 5"	10' 5"	10' 5"
Exterior Width (Including Wheel Wells)	8' 4"	8' 4"	8' 4"	8' 4"	8' 4"
Exterior Width (Slides Out)	9' 3"	N/A	9' 8"	10' 1"	9' 2"
Interior Height	6' 9"	6' 9"	6' 9"	6' 9"	6' 9"
Fresh Water Capacity (Gal.)*	61	61	61	61	61
Gray Waste Water Capacity (Gal.)	30	30	30	30	30
Black Waste Water Capacity (Gal.)	30	30	30	30	30
LP Capacity (lbs.)	60	60	60	60	60
Tire Size	15"	15"	15"	15"	15"
Awning Size	11'	12'	14'	15'	14'

\*Includes Water Heater

\*\*Specifications, weights, measurements, and capacities above are from model year 2022 and are estimates only for model year 2023. Actual specs, weights, measurements, and capacities may be different for model year 2023 than what is listed above. For the most up-to-date model year 2023 specs, please speak with your local Highland Ridge dealer, visit <http://www.HighlandRidgeRV.com>, and check the yellow sticker on the door of your Highland Ridge RV before purchasing, operating, and towing the RV.

TO LEARN MORE VISIT  
[openrangerv.com](http://openrangerv.com)



Highland Ridge RV – Part of the Jayco Family of Companies



## LOCAL DEALER INFO



Due to continual research and advances, manufacturer reserves the right to change specifications, design, price, and equipment without notice, and assumes no responsibility for any error in the literature. Some items shown are not included as standard or optional equipment.  
2032628.2023