

286RLS OPTION C



376FBH OPTION A



371MBH OPTIONS B & C



373RBS OPTION C



379FBS OPTIONS B & C

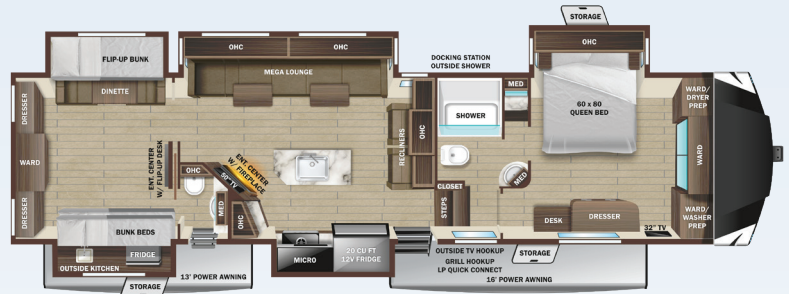

395BHS OPTIONS A & C

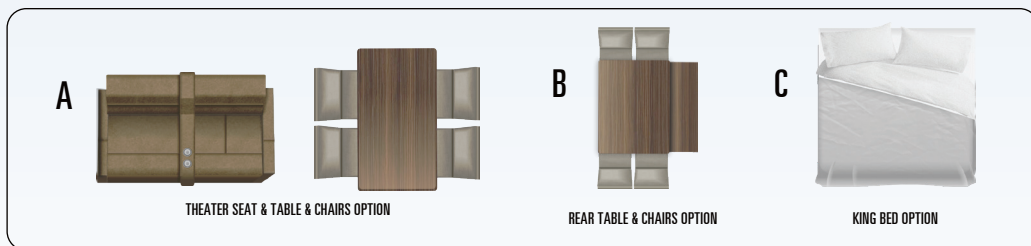

Optional 21 cu. ft. residential refrigerator (available on all floorplans shown)

STANDARD INTERIOR EQUIPMENT

- » 20 cu. ft. 12V refrigerator
- » 60" x 80" residential queen bed with storage below
- » 75 lb. ball bearing drawer guides
- » Cable and satellite prep
- » Ceramic subway tile backsplash
- » Flush floor slides with residential vinyl flooring
- » Glass shower door
- » Hardwood ceiling soffit
- » Hardwood slideout fascia
- » Large freestanding oven and 3-burner range
- » LED interior lighting
- » One-piece fiberglass shower
- » Raised panel hardwood cabinet doors
- » Residential convection microwave
- » Roller day and night shades
- » Table and 4 chairs
- » Theater seating with power recline
- » USB ports in bedrooms
- » VoiceLINK™ voice command system- controls lighting, heating and cooling along with TravelLINK®
- » Wall controlled power vent (kitchen/living room area)
- » Washer/dryer prep

STANDARD EXTERIOR EQUIPMENT

- » 100" wide body frame
- » 2" receiver hitch
- » 3-20 lb. LP bottles
- » 50 amp service
- » ACCU-SLIDE™ slide system (42" deep 4-corner compression)
- » Battery disconnect switch
- » Brass hanger bushings with wet bolts
- » Equa-Flex® axle suspension
- » Exterior grill/griddle quick connect port
- » Frameless windows
- » Laminated block foam floor

- » LevelLoc™ - 4 or 6 point automatic leveling with JT's Strong Arms®
- » PVC roofing membrane (limited lifetime warranty)
- » Rear roof access ladder
- » Self-adjusting electric brakes
- » Spare tire
- » TuffShell™ -vacuum bonded laminated construction, reinforced with heavy-duty fiberglass and welded aluminum frames
- » Xtend Solar I Package (1-200 watt solar panel with 30 amp controller)

EXECUTIVE PACKAGE (MANDATORY)

- » 15,000 BTU A/C with quiet residential return air-bedroom
- » 15,000 BTU A/C with quiet residential return air-main living
- » Bluetooth® ceiling speaker
- » Bluetooth® exterior speakers
- » Cutting board and sink strainer
- » Dome style digital TV antenna with Wi-Fi prep
- » Interior convenience center light
- » Keyed-Alike® entry and baggage doors
- » Motion sensor lighting in bedroom and hallway
- » Painted fiberglass front cap with LED lighting
- » Power awning with LED lighting
- » Quick recovery gas/electric water heater
- » Quick release fresh water drain
- » Residential high-rise faucet with pull-down sprayer
- » Single basin stainless steel under-mount kitchen sink
- » Smart HDTV
- » Solid swing-down entry steps
- » Solid-surface kitchen countertops
- » Stainless steel appliances
- » TravelLINK® - Smart RV system that allows for Bluetooth® control of awnings, lighting, slideouts, heating, cooling and more
- » USB/12V charging port

FOUR SEASON PACKAGE (MANDATORY)

- » Double insulated baggage doors
- » Ducted heat to underbelly with cold air return
- » Enclosed cable operated gate valves
- » Enclosed exterior docking station with black tank flush
- » Heated and enclosed underbelly
- » High performance furnace
- » R-38 reflective foil insulation in ceiling and underbelly
- » R-9 block foam insulation in sidewalls

OPTIONS

- » Xtend Solar II Package (2-200 watt solar panels with 30 amp solar controller and 1800 watt inverter) (Replaces standard Xtend Solar I Package)
- » 21 cu. ft. residential refrigerator
- » BBQ grill
- » Curt AirRide pinbox
- » Dual pane windows
- » Generator prep - LP
- » Heat pump (main A/C)
- » King bed (376FBH)
- » Main bedroom TV - 32"
- » Observation camera
- » Rear table ipo standard sofa (371MBH, 379FBS)
- » Slideout awning covers
- » Theater seats and table ipo standard Mega Lounge sofa (376FBH)
- » Wall controlled power vent - bathroom
- » Wi-Fi router

SPECIFICATIONS <small>May Include Estimated Values</small>	286RLS	376FBH	371MBH	373RBS	379FBS	395BHS
Unloaded Vehicle Weight (lbs.)	11,100	12,750	13,090	13,065	12,730	12,730
Dry Hitch Weight (lbs.)	2,640	2,640	2,480	2,610	2,640	2,650
Gross Vehicle Weight Rating (GVWR)	15,500	15,000	15,500	15,500	15,500	16,250
Cargo (Gross)	2,770	2,250	2,865	2,435	2,770	2,675
Exterior Length (Pin to Rear)	34' 0"	40' 9"	41' 0"	41' 6"	41' 8"	42' 3"
Exterior Length (Overall)	35' 4"	42' 3"	42' 5"	42' 11"	43' 2"	43' 8"
Exterior Height	12' 10"	13' 5"	13' 0"	13' 1"	13' 1"	13' 2"
Exterior Width	8' 4"	8' 4"	8' 4"	8' 4"	8' 4"	8' 4"
Exterior Width (Slides Out)	12' 7"	13' 9"	14' 9"	14' 9"	14' 8"	13' 8"
Interior Height (Upper Deck)	6' 4"	8' 2"	8' 2"	8' 2"	8' 2"	8' 2"
Interior Height (Lower Deck)	8' 2"	6' 4"	8' 2"	6' 6"	6' 4"	6' 5"
Fresh Water Capacity (Gal.)*	85	85	85	85	85	85
Gray Waste Water Capacity (Gal.)	97	97	80	80	97	80
Black Waste Water Capacity (Gal.)	40	80	80	80	80	80
LP Capacity (lbs.)	60	60	60	60	60	60
Tire Size	16"	16"	16"	16"	16"	16"
Awning Size	15'	19'	16'	16', 14'	20'	13', 16'

*Includes water heater

LOCAL DEALER INFO

TO LEARN MORE VISIT
openrangerv.com



Highland Ridge RV – Part of the Jayco Family of Companies



Due to continual research and advances, manufacturer reserves the right to change specifications, design, price, and equipment without notice, and assumes no responsibility for any error in the literature. Some items shown are not included as standard or optional equipment.