

MesaRidge



TRAVEL TRAILERS & FIFTH WHEELS



Highland
RIDGE RV

Own the Outdoors

FLOORPLANS

TRAVEL TRAILERS



FIFTH WHEELS

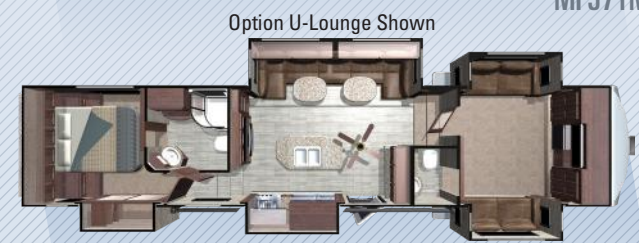

FEATURES

STANDARDS

- » 100" Wide Body Frame
- » 26" x 76" Entrance & Screen Door
- » ACCU-SLIDE Slide System (42" Deep with 4-Corner Compression)
- » 15k Residential Return Air A/C
- » Correct Track Suspension Alignment System
- » Nitrogen Filled Tires with Aluminum Rims
- » Frameless Windows
- » Aluminum Tread Entry Steps
- » No Carpet in Kitchen & Living Areas
- » Patent Flush Floor Slides with Vinyl Flooring (No Carpet)
- » PVC Roofing Membrane (12 Year Warranty/ 10 Year Non-Prorated)
- » Power Awning with LED Light & FLX Guard
- » Heat & Massage Theatre Seats
- » Observation Camera Prep
- » Solar Prep
- » Key-Alike System
- » Wall Controlled Power Vent (Kitchen)
- » Front & Rear Stabilizers
- » Washer/Dryer Prep
- » 100# Ball Bearing Drawer Guides
- » Ladder (TT)
- » Battery Disconnect
- » 84" Slide-Out Height (FW)
- » Night Roller Shades (FW)
- » 21" Oven with Flush Glass Stove Top (FW)
- » 6 Point Auto Leveling with JT Strong Arm Stabilizers (Select Models)
- » French Door to Bedroom (FW)
- » Motion Sensor Light in Bedroom & Hallway (FW)
- » LED Lighting in Ceiling (FW)
- » Fiberglass Front Cap with LED Lights (FW)

OPTIONS

- » A/C - 2nd A/C, 13.5k BTU Ducted (Master Bedroom)
- » BBQ Grill
- » Dual Pane Windows
- » Extreme Arctic Package
- » Fan - Wall Control Power Vent in Kitchen, Living Room (370, 376)
- » Fireplace - Wall Mount (310, 328)
- » King Bed ipo Std Queen Bed (323, 324, 328, 348, 370, 371, 374)
- » Observation Camera
- » Power Front & Rear Stabilizer Jacks
- » Rear Storage Tray
- » Generator Prep - LP (FW ONLY)
- » Refrigerator - 12cu ipo Std 8cu (N/A 337), 18cu ipo 8cu (310, 323, 324, 337), - 23cu ipo 8cu (328, 348, 370, 371,374, 376)
- » TV - Bunk Room (371), Outside Kitchen (272, 292, 310, 328, 371, 374)
- » U-Lounge ipo Std. Theater Seats/Table (310, 328, 374, 376)
- » Slide-Out Awning Covers: 3 (337,348), 4 (370, 371,374,376)

SPECIFICATIONS

| | MR272RLS | MR292RLS | MR310BHS | MR323RLS | MR324RES | MR328BHS | MF337RLS | MF348RLS | MF370RBS | MF371MBH | MF374BHS | MF376FBH |
|-------------------------------------|----------|----------|----------|----------|----------|----------|----------|----------|----------|----------|----------|----------|
| Square Feet | 325 | 325 | 386 | 366 | 366 | 356 | 350 | 386 | 429 | 430 | 425 | 429 |
| UVW | 7755 | 8370 | 9265 | 8815 | 9320 | 9860 | 9657 | 10485 | 12145 | 12505 | 12300 | 12015 |
| Hitch Weight | 830 | 974 | 1227 | 1081 | 1080 | 1280 | 2351 | 2440 | 2640 | 2515 | 2520 | 2785 |
| GVWR | 9990 | 10400 | 11500 | 11435 | 11480 | 11300 | 12720 | 13995 | 16470 | 16470 | 16470 | 16460 |
| Cargo (Gross) | 2235 | 2030 | 2235 | 2620 | 2160 | 1440 | 3063 | 3510 | 4325 | 3965 | 4170 | 4445 |
| Length (Pin to Rear) | 35' | 35' | 33' 6" | 37' 8" | 37' 8" | 35' | 33' 8" | 36' | 42' 5" | 41' 4" | 40' 6" | 41' 7" |
| Ext. Height | 140" | 140" | 140" | 140" | 140" | 140" | 157" | 157" | 157" | 157" | 157" | 157" |
| Ext. Width | 100" | 100" | 100" | 100" | 100" | 100" | 100" | 100" | 100" | 100" | 100" | 100" |
| Ext. Width (Slides Out) | 165" | 165" | 165" | 165" | 165" | 165" | 179" | 179" | 165" | 165" | 155" | 165" |
| Interior Height (Overall) | 84" | 84" | 84" | 84" | 84" | 84" | 98" | 98" | 98" | 98" | 98" | 98" |
| Interior Height (Upper Deck) | - | - | - | - | - | - | 76" | 76" | 76" | 76" | 76" | 76" |
| Fresh Water (Gal.) | 50 | 50 | 50 | 50 | 50 | 50 | 85 | 85 | 85 | 85 | 85 | 85 |
| Gray Water (Gal.) | 62 | 57 | 31 | 88 | 88 | 82 | 57 | 57 | 82 | 114 | 98 | 98 |
| Waste Water (Gal.) | 31 | 31 | 62 | 31 | 31 | 82 | 41 | 41 | 41 | 41 | 82 | 82 |
| LP Capacity (lbs.) | 60 | 60 | 60 | 60 | 60 | 60 | 60 | 60 | 60 | 60 | 60 | 60 |
| Tire Size | 15" | 15" | 16" | 16" | 16" | 15" | 16" | 16" | 16" | 16" | 16" | 16" |
| Awning Size | 20' | 18' | 19' | 15' | 15' | 11', 10' | 16' | 16' | 18', 12' | 19' | 16', 11' | 19' |

CONSTRUCTION



1 | ROOF

- » Double batten insulation layered with radiant foil
- » Screw-mounted plywood decking topped with premium quality PVC
- » No treatment required! Will not chalk or spot
- » Heat reflecting properties keep coach cooler in the summer

2 | SLIDE OUTS

- » Best in class slide height and depth
- » Flush floor and above floor slides
- » Accu-Slide cable system with four points of compression
- » Laminate components plus 3M flashing tape along corners to prevent leaks

3 | SIDEWALLS

- » Lightweight, double-welded aluminum walls
- » Slide roof frames laminated with rigid foam insulation

4 | MAIN BODY

- » Built with 8" & 10" steel I-beams
- » 6,000 & 7,000 lb. axles with self-adjusting brakes
- » Aluminum wheels with nitrogen-filled tires
- » Industry-leading unique heating system

5 | DOORS & LOCKS

- » Oversize entrance door with large window, built-in screen doors, and integrated window shades
- » Double-insulated passage and storage doors with slam latches on secure and convenient key-alike system

6 | FLOORS

- » Double-welded framed floors
- » Insulated with rigid foam wrapped in radiant foil, anti-puncture Darco material, and strengthened with an overlapping double layer of laminate

INDUSTRY-LEADING HEATING SYSTEM

Oversize 4-inch heat ducts run from the furnace down to the fully enclosed underbelly and wrap around the tanks suspended between the chassis I-beams. Holding tanks are warmed by the forced air heat which prevents freeze-ups.

A return at the end of the tank connecting back into the coach provides the necessary air flow, eliminating the need for a pressurized system.

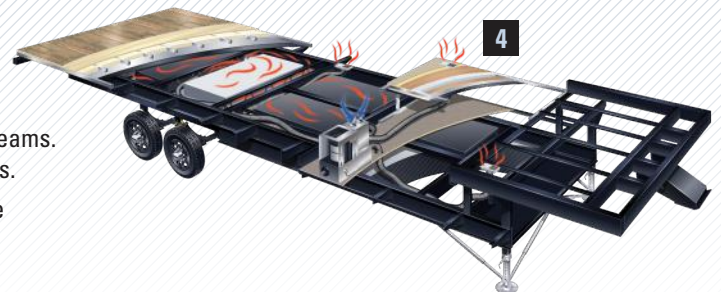

Your Mesa Ridge Dealer:



Own the Outdoors

For more information visit us at:
www.HighlandRidgeRV.com

Due to continual research and advances, manufacturer reserves the right to change specifications, design, price, and equipment without notice, and assumes no responsibility for any error in the literature. Some items shown are not included as standard or optional equipment.