

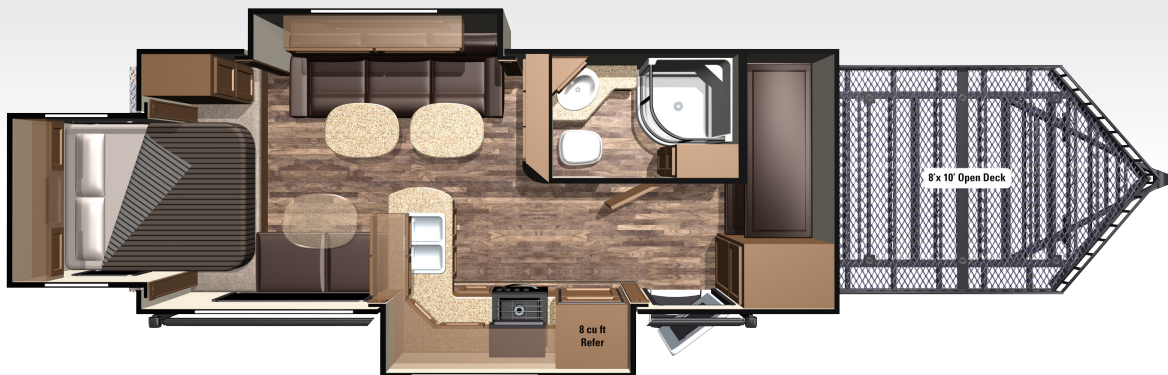

# 2016 HIGHLANDER HT21FBD

(6)



## STANDARD FEATURES

- » "Maxx Air" Vent Cover
- » 100" Wide Body Frame
- » 30 Gal Fuel Cell
- » 30# LP Bottles (2)
- » 50 Amp Service
- » Ext. Utility Center w/ Black Tank Flush
- » Front & Rear Stabilizer Jacks
- » Generator Prep
- » Heavy Duty Full Extension Drawer Guides
- » Lippert Equa-Flex Suspension
- » Lippert Wide-Stance Axles
- » LP Quick Connect
- » Nitrogen Filled Radial Tires
- » Porcelain Toilet w/ Foot Pedal Flush
- » Power Tongue Jack
- » Prepped for Observation Camera
- » PVC Roof Material
- » Washer/Dryer Prep

## OPTIONAL FEATURES

- » 15k BTU Main A/C
- » 2 Bar Stools
- » 24" Bedroom TV
- » BBQ Grill
- » Dual Pane Windows
- » Dyson Vacuum Cleaner
- » Extreme Arctic Package
- » Fantastic Fan in Bathroom
- » Fantastic Fan in Bedroom
- » Furrion Observation Camera
- » Indoor/Outdoor Carpet - 7'x9'
- » Ladder
- » Lock Arm Stabilizer Bars
- » Power Front & Rear Stabilizer Jacks
- » Slide-Out Awning Covers
- » Spare Tire

## SPECIFICATIONS

Square Feet	291
UVW	7745
Hitch Weight	410
GVWR	9995
Cargo (Gross)	2250
Exterior Length (Box)	31'5"
Exterior Length (Overall)	34'5"
Exterior Height	138"
Exterior Width	100"
Fresh Water (Gal.)	50
Gray Water (Gal.)	62
Waste Water (Gal.)	31
Tire Size	15"
Awning Size	18'
Sleeping Capacity	6
Bed Size	60"x 80" Queen
Sofa Size/Type	2-Cushion Full Tri-Fold Bed
Shower Size	34" Radius

## MANDATORY PACKAGES

### EXECUTIVE PACKAGE

- » ATWOOD® 18 GPH Quick Recovery Gas/Electric Water Heater
- » Bedroom Speakers
- » Concealed Hinges
- » Crown Molding
- » Dometic® Brisk II 13.5k BTU Air Conditioner w/"Quick Cool" Feature (Main A/C)
- » Fantastic Fan in Kitchen
- » Frameless Windows
- » Full View Vented Entrance Door
- » Furrion DV5600 Entertainment System
- » Furrion LED TV
- » Furrion Soundbar in Living Area
- » KING Jack™ Digital TV Antenna with Built-in Signal Meter
- » LED Lighting in Ceiling
- » Longitude Power Awning w/LED Awning Light & FLX Guard
- » Multi-Port Satellite Hook-Up
- » Norcold® 8 Cu. Ft. Refrigerator
- » USB/12V Charging Port
- » Western Aspen Cabinet Doors

### FOUR SEASONS PACKAGE

- » ATWOOD® Next Gen High Performance Furnace
- » Digital Thermostat
- » Double Insulated Baggage Doors
- » Heated & Enclosed Dump Valves
- » Heated & Enclosed Underbelly
- » Insulated Slide Floors
- » R-38 Insulation in Roof & Floor
- » R-9 Insulation in Sidewall



For more information visit us at:  
[www.HighlandRidgeRV.com](http://www.HighlandRidgeRV.com)

Note: Features subject to change without notice. Rev. 12/09/15

### DÉCOR OPTIONS



## MORE ROOM LESS WEIGHT

*This is our mission at Highland Ridge RV, Inc. It's the life blood that runs in our veins. It drives us to innovate and revolutionize the RV industry and it's why our products are 10 - 15% lighter than the competition.*